

## Drive Wheel Axle Replacement Instructions

### Pre-fitting the axle

1. Insert axle and align one set of holes.
2. Insert bolt to keep first set of holes aligned.
3. Check alignment of second set of holes, insert bolt if possible.

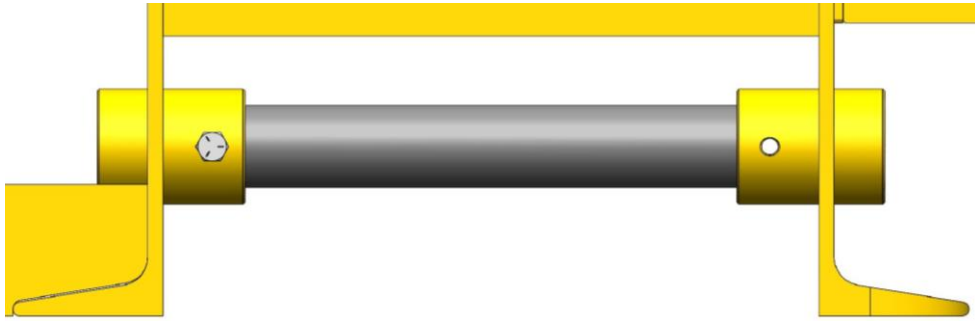

4. If both bolts can be inserted, the axle is ready for installation.
5. If second bolt cannot be inserted but the second set of holes overlap, chase out second set of holes with extended  $\frac{1}{4}$  inch drill bit.

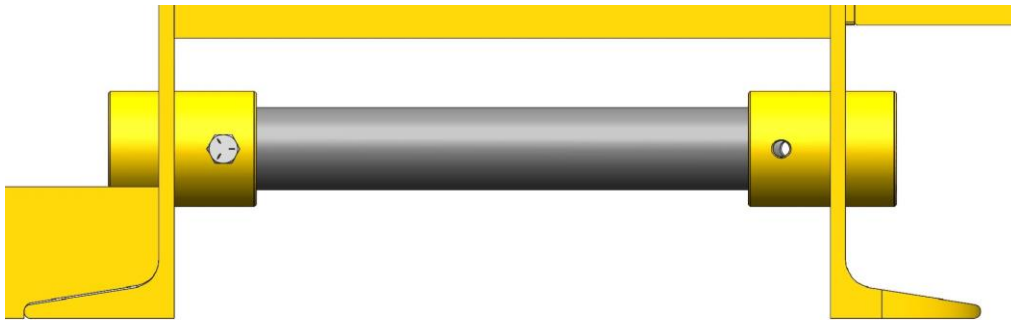

6. Once both bolts can be inserted, the drive wheel axle is ready for installation.